



# **RALLY & ROAR CARD SHUFFLER**

**AUTOMATICALLY SHUFFLES  
UP TO 6 DECKS OF  
STANDARD POKER SIZE CARDS**

## **HOW TO USE:**

- 1. PLACE YOUR BATTERIES INTO THE BATTERY HOLDERS IN THE BOTTOM OF CARD SHUFFLER. THERE ARE TWO BATTERY COMPARTMENTS, ONE ON EACH SIDE.**
- 2. SPLIT YOUR CARDS INTO TWO SAME SIZE PILES. PLACE ONE PILE ON EACH SIDE OF THE SHUFFLER IN THE CARD HOLDER SECTION.**
- 3. BE SURE THAT LIKE SIDES ARE PLACED UP.**
- 4. PRESS DOWN ON THE LEVER OPERATION BUTTON. YOU CAN ADJUST YOUR TOUCH TO EITHER SLOW IT DOWN OR SPEED IT UP.**

**RALLYROARGAMES@GMAIL.COM**



# RALLY & ROAR CARD SHUFFLER

## TROUBLESHOOT GUIDE

In the rare case your shuffler isn't operating properly, often times its an easy fix. If one or both sides do not spin when you press the long black "Press down to operate" tab, then the problem is in the gears. The gears may have shifted during shipping or moving.

There is a long, thin gear (B) that touches both the motor gear (A) and the thicker gear (C) that moves the cards. Occasionally these gears close together, which caused friction and stops them from spinning.

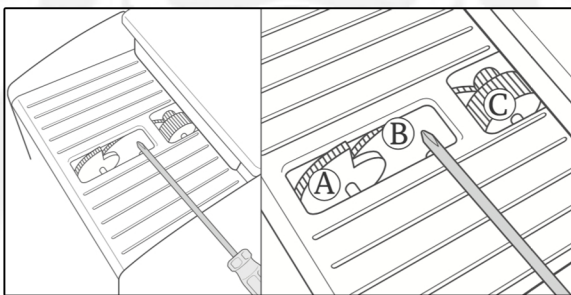

To reposition your gears:

1. Use a long thin tool as tweezers, narrow screwdriver, bobby pin, etc.
2. Place your tool on gear (B), then gently push in the opposite direction of any gear that is touching.
3. Press the "Press down to operate" tab to check if function has been restored.
4. If the problem persists, be sure to check your batteries.

If problem persists please contact us at  
[rallyroargames@gmail.com](mailto:rallyroargames@gmail.com)